

TOOLS REQUIRED / OUTILS REQUIS

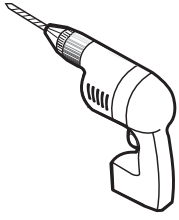

DRILL
PERCEUSE

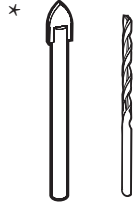

1/4" & 1/8" DRILL BITS
MÈCHE 1/4" & 1/8"

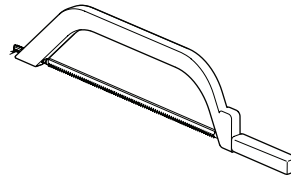

HACKSAW
SCIE À MÉTAUX

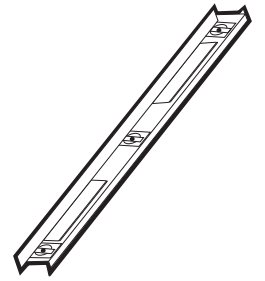

LEVEL
NIVEAU



PENCIL
CRAYON

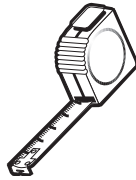

MEASURE TAPE
RUBAN À MESURER



PLIERS
PINCE



SCREWDRIVER
TOURNEVIS

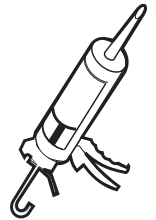

SILICONE
SCÉLLANT

* Use a 1/4" drill bit for ceramic when drilling into ceramic tiles • * Utiliser une mèche à céramique de 1/4" lors du perçage des tuiles en céramique.

POSSIBLE CONFIGURATIONS / CONFIGURATIONS POSSIBLES

*

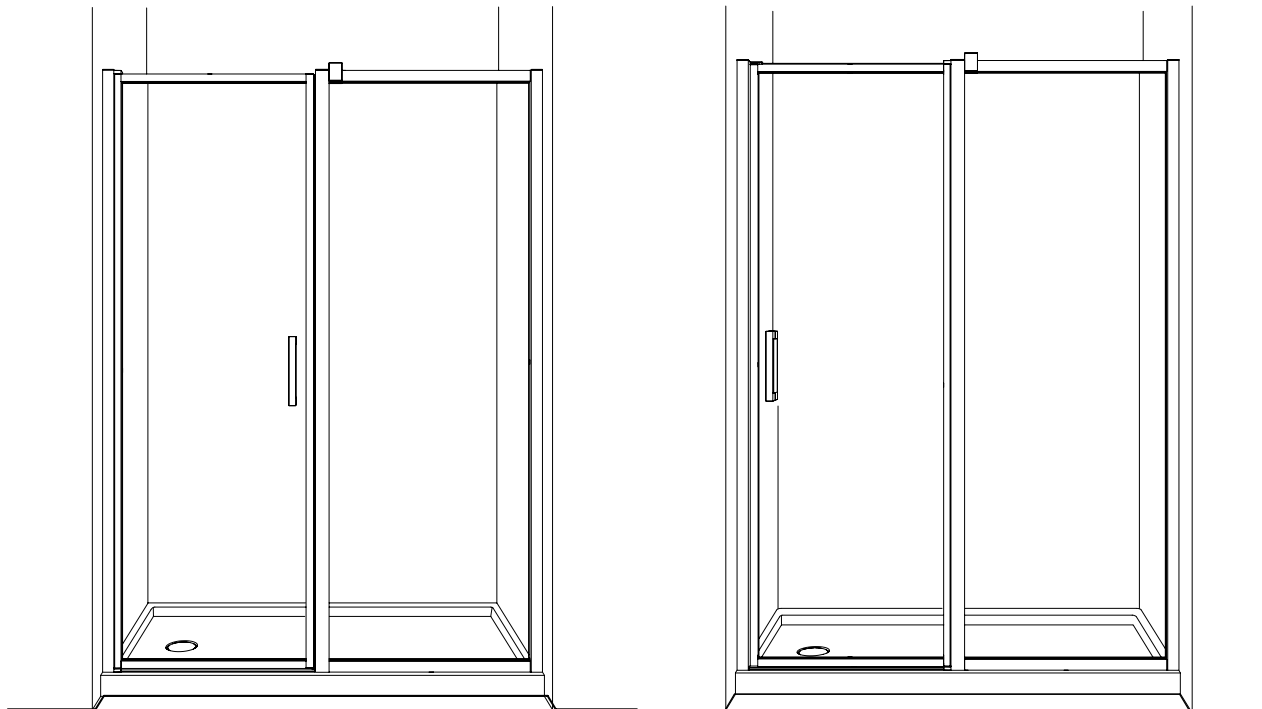

Reversible • Réversible

* This configuration is illustrated in this manual. • * Cette configuration est illustrée dans ce manuel.

**PARTS AND HARDWARE LISTING /
LISTE DES PIÈCES ET QUINCAILLERIE**

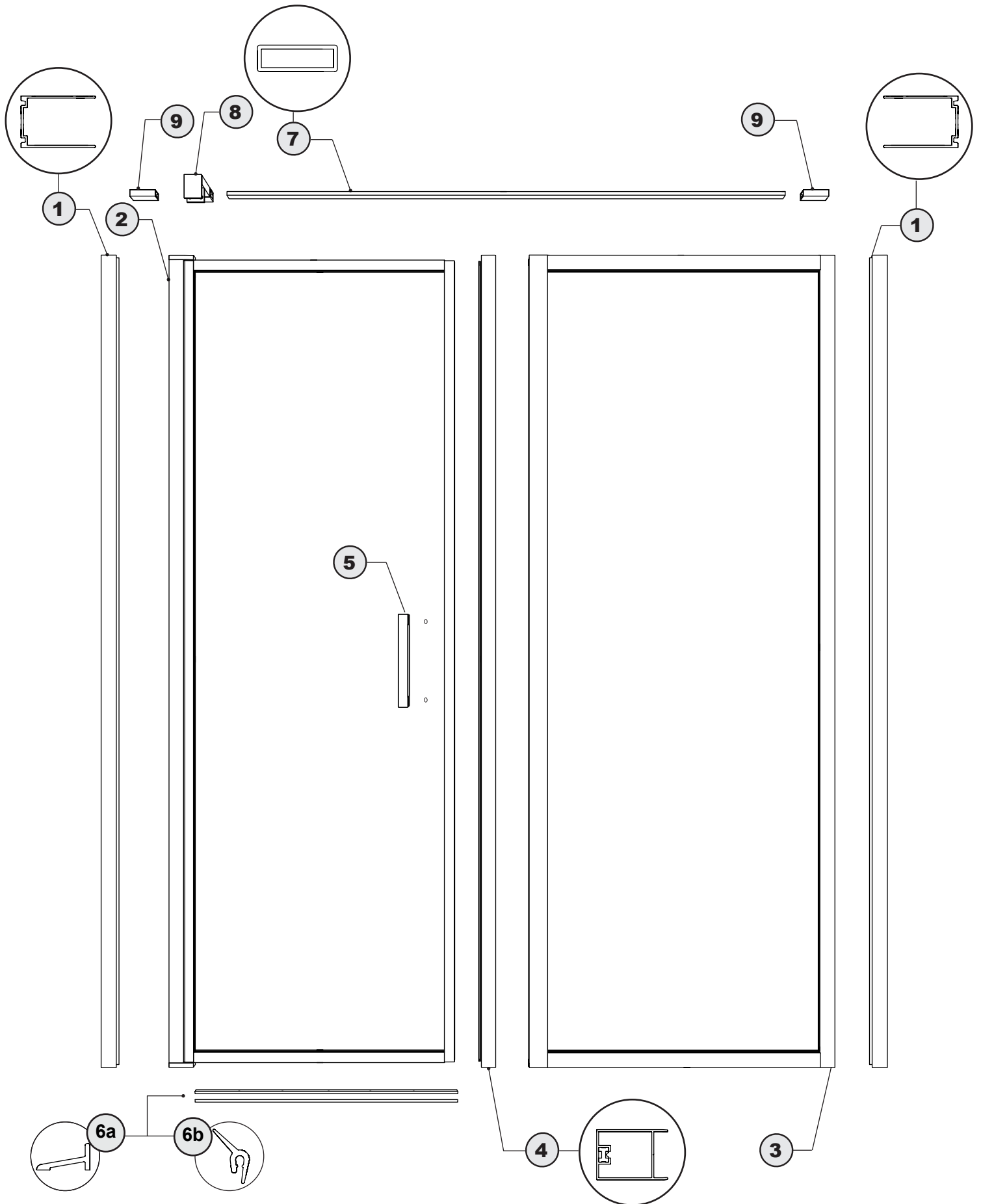

**PARTS AND HARDWARE LISTING /
LISTE DES PIÈCES ET QUINCAILLERIE**

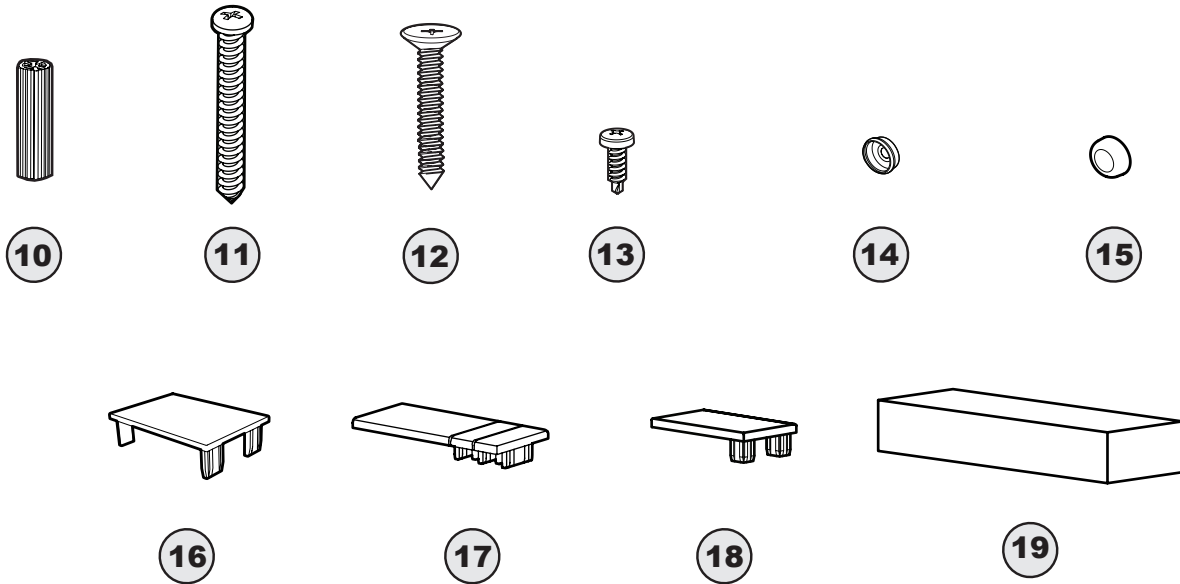

ITEM	FLEURCO CODE	PARTS AND HARDWARE / PIÈCES ET QUINCAILLERIE	QTY
1	ELE-WJAMB-XX-79	WALL JAMB / JAMBAGE	2
2		DOOR PANEL / PANNEAU DE PORTE	1
3		FIXED PANEL / PANNEAU FIXE	1
4	LAP-MAGEXP-XX-79	MAGNETIC EXPANDER / EXTENSEUR MAGNÉTIQUE	1
5		HANDLE / POIGNÉE	1
6A	PLAT-THRESH-33-72 ++15405	THRESHOLD / SEUIL	1
6B	COEX-LA415-40-33 COEX-LA415-40	THRESHOLD GASKET / JOINT DU SEUIL	1
7	LAVBAR-XX-70	SUPPORT BAR / BARRE DE SUPPORT	1
8	LAV-BRACKET-S-XX	GLASS MOUNT BRACKET / SUPPORT DE VERRE	1
9	LAVBRACKET-33 PJ-BRACKET-XX	WALL MOUNT BRACKET / SUPPORT MURAL	2
10		WALL PLUG / CHEVILLE	8
11		PAN HEAD SCREW / VIS À TÊTE CYLINDRIQUE	6
12		FLAT HEAD SCREW / VIS À TÊTE PLATE	2
13		PAN SELF-DRILLING SCREW / VIS PAN AUTO-PERÇANTE	9
14		BACK SCREW CAP / CAPUCHON COUVRE-VIS ARRIÈRE	15
15		SCREW CAP / CAPUCHON COUVRE-VIS	15
16	LA-RP-CAP-33-79 LA-RP-CAP-XX	FRAME CAP / CAPUCHON DU CADRE	2
17	ELE-WJCAP-XX	WALL JAMB CAP / CAPUCHON DU JAMBAGE	2
18	LAP-F-CAP-XX	FIXED PANEL CAP / CAPUCHON DE L'EXTENSEUR	1
19		SHIM / CALE	1

LEGEND / LÉGENDE
 XX = FINISH/FINI (11, 25, 33)
 ** = LENGTH / LONGUEUR (54, 60, 79, 86 ETC)
 ++ = CODE / CODE (AC, ABN)