

## TOOLS REQUIRED / OUTILS REQUIS

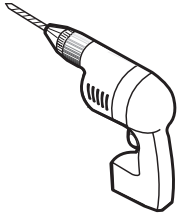

**DRILL**  
PERCEUSE

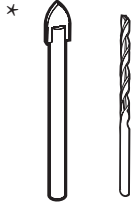

**1/4" & 1/8" DRILL BITS**  
MÈCHE 1/4" & 1/8"

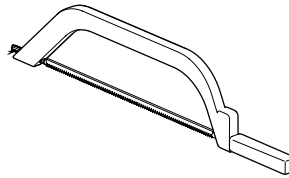

**HACKSAW**  
SCIE À MÉTAUX

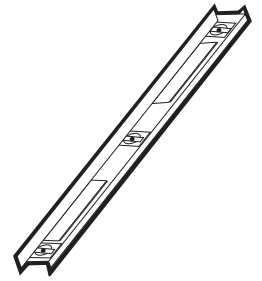

**LEVEL**  
NIVEAU



**PENCIL**  
CRAYON

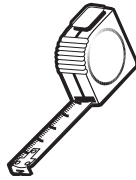

**TAPE MEASURE**  
RUBAN À MESURER



**PLIERS**  
PINCE



**SCREWDRIVER**  
TOURNEVIS

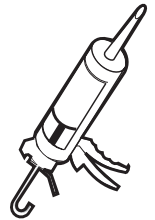

**SILICONE**  
SCÉLLANT

\* Use a 1/4" drill bit for ceramic when drilling into ceramic tiles • \* Utiliser une mèche à céramique de 1/4" lors du perçage des tuiles en céramique.

## POSSIBLE CONFIGURATIONS / CONFIGURATIONS POSSIBLES

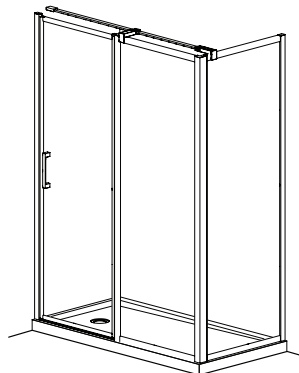
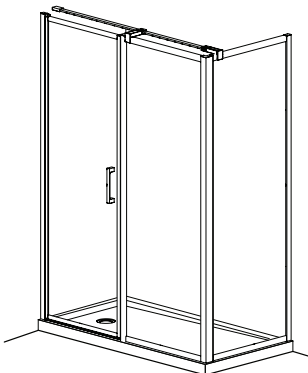
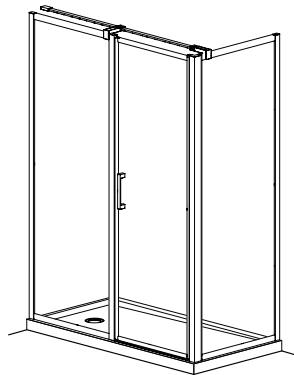
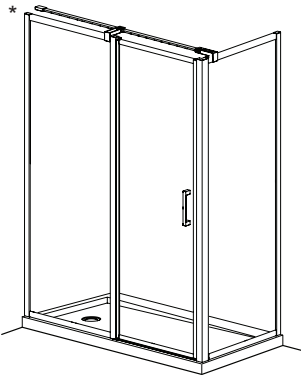

Reversible • Réversible



**THIS DOOR OPENS OUTWARDS AND INWARDS, CONFIRM THE PLUMBING LOCATION BEFORE STARTING THE INSTALLATION**

**CETTE PORTE S'OUVRE VERS L'INTÉRIEUR ET L'EXTÉRIEUR. CONFIRMER L'EMPLACEMENT DE LA PLOMBERIE AVANT DE COMMENCER L'INSTALLATION**

\* This configuration is illustrated in this manual. • \* Cette configuration est illustrée dans ce manuel.

**PARTS AND HARDWARE LISTING /  
LISTE DES PIÈCES ET QUINCAILLERIE**

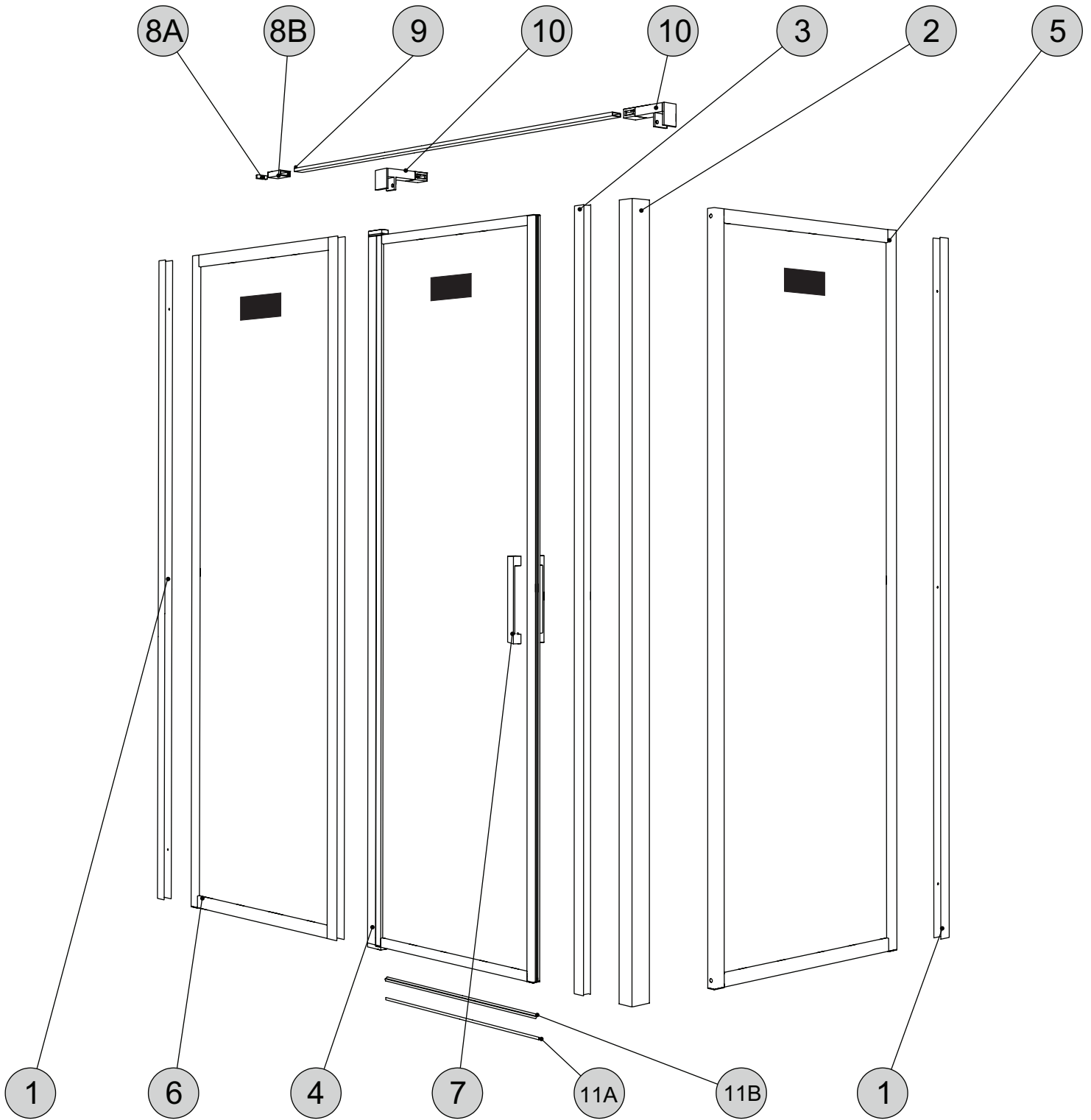

**THE LABEL INDICATES THE INTERIOR AND  
EXTERIOR OF THE SHOWER**  
L'ÉTIQUETTE INDIQUE L'INTÉRIEUR ET  
L'EXTÉRIEUR DE LA DOUCHE

**PARTS AND HARDWARE LISTING /  
LISTE DES PIÈCES ET QUINCAILLERIE**

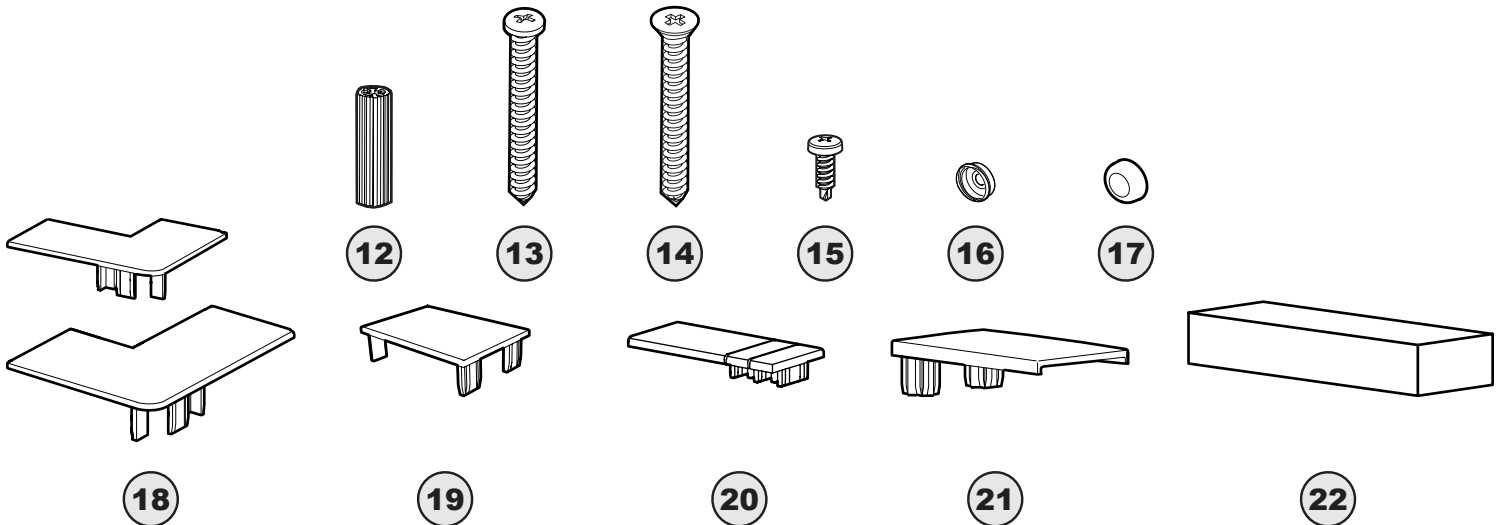

ITEM	FLEURCO CODE	PARTS AND HARDWARE / PIÈCES ET QUINCAILLERIE	QTY
1	ELE-WJAMB-XX-79	WALL JAMB / JAMBAGE	2
2	LA-CJAMB-XX-79	CORNER JAMB / JAMBAGE DU COIN	1
3	LAP-MAGEXP-XX-79	MAGNETIC EXPANDER / EXTENSEUR MAGNÉTIQUE	1
4		DOOR PANEL ASSEMBLY / ASSEMBLAGE DU PANNEAU DE PORTE	1
5		RETURN PANEL / PANNEAU DE RETOUR	1
6		FIXED PANEL / PANNEAU FIXE	1
7		HANDLE / POIGNÉE	1
8	LAVBRACKET-33	WALL MOUNT BRACKET / SUPPORT MURAL	1
	PJ-BRACKET-XX		
9	LAVBAR-XX-70	SUPPORT BAR / BARRE DE SUPPORT	1
10	LAV-BRACKET-S-XX	GLASS MOUNT BRACKET / SUPPORT DE VERRE	2
11A		THRESHOLD / SEUIL	1
11B	COEX-LA415-40-33	THRESHOLD GASKET / JOINT DE SEUIL	1
	COEX-LA415-40		
12		WALL PLUG / CHEVILLE	7
13		PAN HEAD SCREW / VIS À TÊTE CYLINDRIQUE	6
14		FLAT HEAD SCREW / VIS À TÊTE PLATE	1
15		PAN SELF-DRILLING SCREW / VIS PAN AUTO-PERÇANTE	15
16		BACK SCREW CAP / CAPUCHON COUVRE-VIS ARRIERE	21
17		SCREW CAP / CAPUCHON COUVRE-VIS	21
18	LA-CJAMB-CAP-33-79	CORNER JAMB CAP / CAPUCHON DU JAMBAGE DE COIN	1 SET
	LA-CJAMB-CAP-XX		
19	LA-RP-CAP-33-79	FRAME CAP / CAPUCHON DU CADRE	4
	LA-RP-CAP-XX		
20	ELE-WJCAP-XX	WALL JAMB CAP / CAPUCHON DU JAMBAGE	2
21	LAP-F-CAP-XX	FIXED PANEL CAP / CAPUCHON DU PANNEAU FIXE	1
22		SHIM / CALE	1

**LEGEND / LÉGENDE**  
 XX = FINISH/FINI (11, 25, 33)  
 \*\* = LENGTH / LONGUEUR (54, 60, 79, 86 ETC)  
 ++ = CODE / CODE (AC, ABN)